

Recommended P.C.Board Layout(Top View)
(PCB Board Tolerance±0.05)

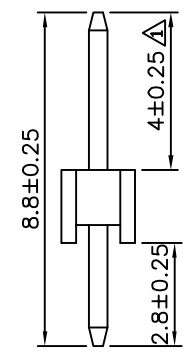
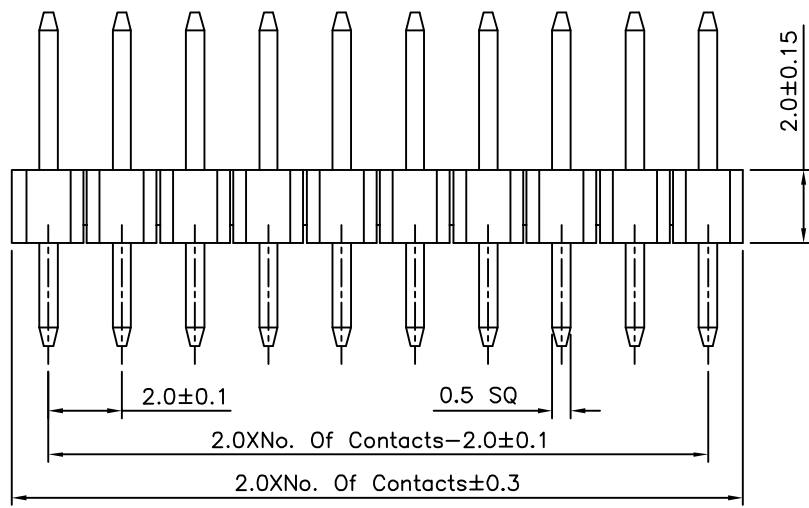
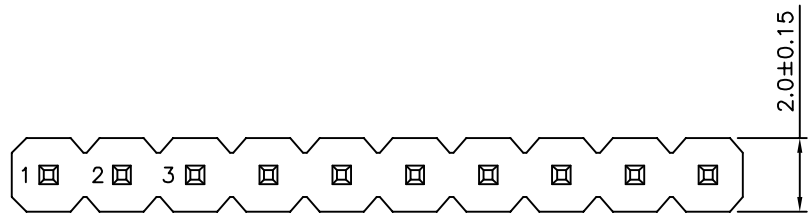

SPECIFICATION
 ⚠ Current Rating:1.5 Amps
 ⚠ Withstand Voltage:500V AC
 Contact Resistance:20 Milliohms Max.
 ⚠ Insulation Resistance:1000 Megaohms Min.
 Operation Temperature Range:-40°C~+105°C
 Insulator:PA6T(UL94V-0),Black
 Contact:Brass,Gold Flash Over Nickel
 RoHS Compliant

4UCON 元化興業股份有限公司
 4UCON TECHNOLOGY INC.

DRAWING No.		APPROVED BY		UNLESS OTHERWISE SPECIFIED TOLERANCES ARE ⚠ X. ±0.25 X.* ±2° .X ±0.20 .X* ±1.5° .XX ±0.15 .XX* ±1° .XXX ±0.10 .XXX* ±0.5°
00207		EMILY		
		CHECKED BY		
		HZF		
		DRAWING BY		UNIT mm
		YBL		
SCALE	NONE	REV.	A1	NO. REV.

⚠ A1	Modify Data	HZF	01/07/2014	
⚠ A0	NEW RELEASE	HZF	01/21/2011	
NO. REV.	REVISIONS	CHK	DATE	